

# Lighting

## Linear luminaire For fluorescent lamps

GRP

6001/522-9510-15-131 Art. No. 220897



- Can be used in Ex Zones 1, 2, 21 and 22
- Explosion-protected linear luminaire with two fluorescent lamps: 18 W, 36 W and 58 W
- Extremely robust: Impact strength rating of IK10

WebCode 6001A



The 6001 EXLUX luminaire is suited to normal lighting applications in almost any facility. In no time at all and with very little effort, using the accessories it can be fitted to the wall, ceiling or a pole, or alternatively, it can be suspended. The practical central lock has a safety switch that disconnects the power supply at all poles when the plastic enclosure is opened. Lightweight yet strong: The high-quality workmanship makes this luminaire robust and minimises maintenance requirements.

### Technical Data

#### Explosion Protection

Application range (zones)	1 2 21 22
IECEX gas certificate	IECEX PTB 13.0003
ATEX gas certificate	PTB 13 ATEX 2004
IECEX dust certificate	IECEX PTB 13.0003
ATEX dust certificate	PTB 13 ATEX 2004
Certificate EAC	TS RU S-DE.GB04.B.00308
Ambient temperature °C	-30 ... +50 °C
Gas explosion protection IECEx	Ex db eb IIC T4 Gb
Gas explosion protection ATEX	⊕ II 2 G Ex db eb IIC T4 Gb
Gas explosion protection EAC	1 Ex d e IIC T4 Gb
Dust explosion protection IECEx	Ex tb IIIC T80 °C Db
Dust explosion protection ATEX	⊕ II 2 D Ex tb IIIC T80 °C Db
Dust explosion protection EAC	Ex tb IIIC T80°C Db
Certificates	ATEX (PTB), Brazil (ULB), China (CQST), EAC (STV), IECEx (PTB), India (PESO), Polen (CNBOP), Taiwan (ITRI)
Ship approval	BVIS, DNVGL
Languages of the documentation	German English

#### Electrical Data

Ex version	Yes
Rated operational voltage AC	220 – 240 V
Rated operational voltage AC	220 – 240 V
Rated operational voltage DC	220 – 240 V
Frequency range	50 – 60 Hz

# Lighting

Linear luminaire For fluorescent lamps

GRP

6001/522-9510-15-131 Art. No. 220897



## Electrical Data

Lamp wattage	18 W
--------------	------

## Lighting Data

Number of Lamps	2
Lamp wattage	18 W
Lamp	G13 lamp base
Luminaire efficacy	0 lm/W
Luminous flux	0 lm
Colour temperature	0 K

## Ambient Conditions

Ambient temperature °F	-999 - -999 °F
Ambient temperature min.	-30 °C
Ambient temperature max.	+50 °C
Ambient temperature	-30 °C ... +50 °C

## Mechanical Data

Version	Standard
Degree of Protection IP (IEC 60598)	IP66/IP67
Protection class	I (with inner PE connection)
Enclosure material	Polyester resin, Glass fibre reinforced
Sealing material	Silicone
Material translucent cover	Polycarbonate
Installed terminal strip	PE + N + L1 + L2 + L3
Connection terminals solid max.	4 mm <sup>2</sup>
Connection terminals finely-stranded max.	4 mm <sup>2</sup>
Lighting lock	Central lock , For box spanner actuation
Type of connection cable	Solid Finely stranded Stranded
Design size	2
Width	184 mm
Height	125 mm
Length	700 mm
Impact strength (IK code)	IK10 (IEC 62262)
Enclosure colour	Light grey (RAL 7035)
Weight	4.5 kg

## Components

Threaded plate	2x plastic
Ballast	6042/243-21
Through wiring	With 5 conductors 2.5 mm <sup>2</sup>
Note: Through wiring	Max. 3x16 A
Drilled holes	3 x M25
Screw connections	2 x M25 Ø 7 – 17 mm
Material of cable entry	Polyamide, black
Stopping plug	2 x M25 x 1.5
Stopping plug material	Polyamide, black

# Lighting

## Linear luminaire For fluorescent lamps

### GRP

6001/522-9510-15-131 Art. No. 220897



#### Dimensional Drawings (All Dimensions in mm [inches]) – Subject to Alterations

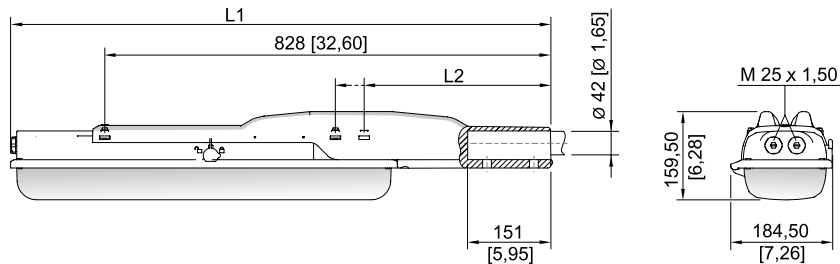

Size 2: L1 = 978 mm; L2 = 390 mm  
Size 4: L1 = 1587 mm; L2 = 338 mm  
EXLUX 6001 with pole mounting sleeve

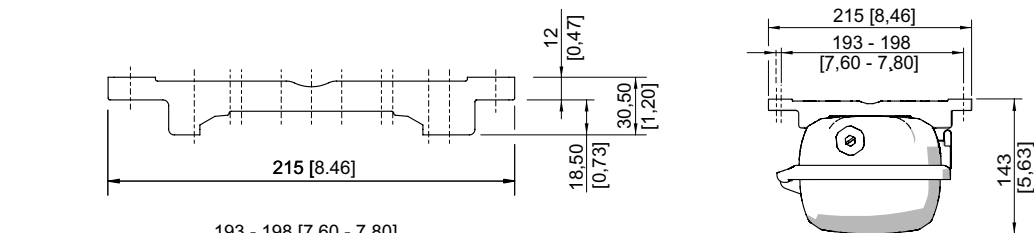

Mounting rail

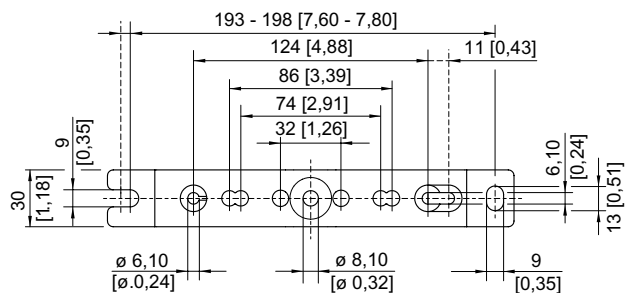

Mounting rail

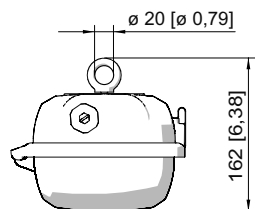

Ring bolt fitted in insert nut of the luminaire

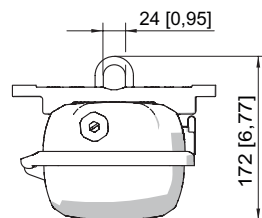

Mounting bracket fitted in mounting rail

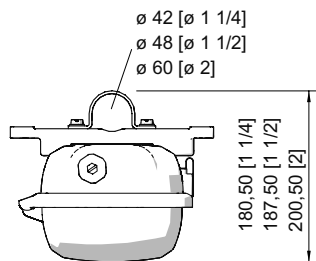

Pipe clamp fitted in mounting rail

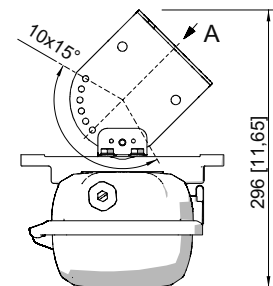

A

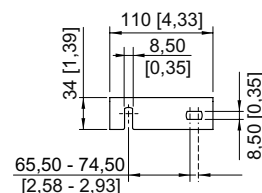

Wall mounting bracket fitted in mounting rail

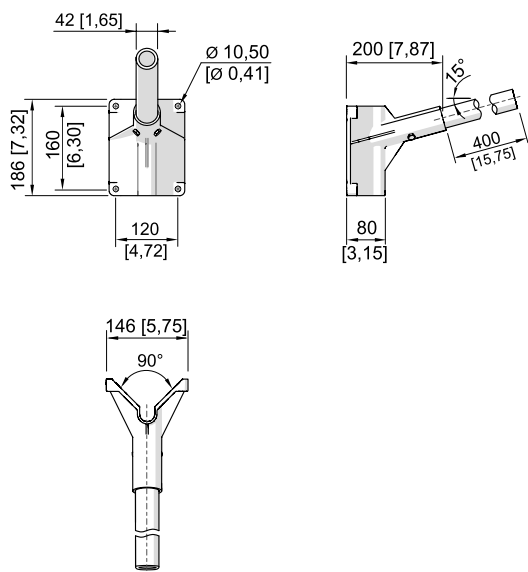

Bracket for wall mounting with pipe section

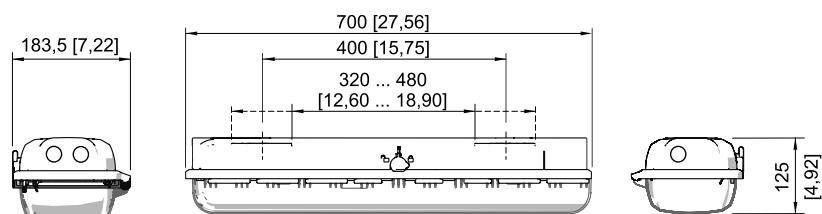

Size 2

## Accessories and Spare Parts

### Bracket for wall mounting with tube

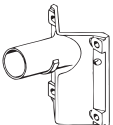
	Art. No.
	for side entry lamp; with tube, length 400 mm, d 42 mm 108947

### Breather

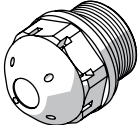
	Art. No.
	Thread: M25 x 1.5; 1 pc; for installation in lights; in moulded material; without counter nut 138573
	Thread: M25 x 1.5; 20 pc; for installation in lights; in moulded material; without counter nut 138576

### Ceiling and wall mounting bracket

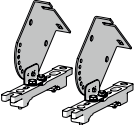
	Art. No.
	mounted on a mounting rail for a variable mounting distance; Material: stainless steel; Lamp can be swiveled in steps of 15°; 1 pair 222827

### Contact Element

	Art. No.
	8080/1-3-L 2 NC contact element 132527



# Lighting

Linear luminaire For fluorescent lamps

GRP

6001/522-9510-15-131 Art. No. 220897

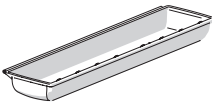
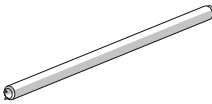
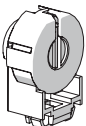
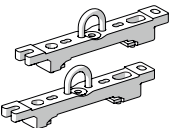
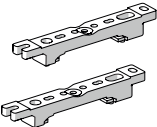
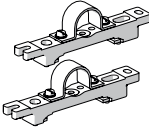

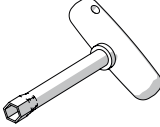
		Art. No.
<b>Cover</b>		
	for luminaire size 2	222427
<b>Fluorescent lamp</b>		
	18 W, 1350 lm	108952
<b>Lamp holder</b>		
	G13 Ex e lamp holder for light fittings with T8 fluorescent lamps for use in Zone 1	117252
<b>Mounting bracket</b>		
	mounting clamp mounted on a mounting rail for a variable mounting distance; 1 pair	222456
<b>Mounting rail</b>		
	for a variable mounting distance; 1 pair	222826
<b>Pipe clamp</b>		
	R 1 1/2"; with mounting rail for a variable mounting distance; Material: stainless steel; 1 pair	222459
	R 1 1/4"; with mounting rail for a variable mounting distance; Material: stainless steel; 1 pair	222458
	R 2"; with mounting rail for a variable mounting distance; Material: stainless steel; 1 pair	222460
<b>Pole mounting sleeve</b>		
	for the subsequent mounting on lights 18 W and 36 W, completely with assembly parts	227512
<b>Ring bolt</b>		
	M8, direct mounting in insert nuts; 1 pair	115736
<b>Socket Key</b>		
	M8 / wrench size 13; to open/close the central locking	222430

## Lighting

Linear luminaire For fluorescent lamps

GRP

6001/522-9510-15-131 Art. No. 220897

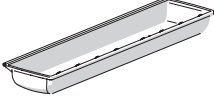

Cover		Art. No.
	for luminaire size 2 (resistant to aromatic substances)	256534

We reserve the right to make alterations to the technical data, dimensions, weights, designs and products available without notice. The illustrations cannot be considered binding.